



# Welcome to Mont Tremblant, Canada

IEEE Session # 45

September 25-28, 2006



# Logistics



- Host: Frank Draper, Wavesat, Brian Kiernan, Interdigital and Keith Doucet, Redline Communications.
- Location: Mont Tremblant, Quebec, Canada
- Dates: September 25-28, 2006
- Mont Tremblant Convention Center is reserved in totality (12 meeting rooms, total capacity of 400)
- WLAN will be supplied and monitored by Nortel as a sponsor to the event.
- Block of sleeping rooms are reserved in 3 hotels in the pedestrian village. Rate: \$105 CAD to \$CAD175 until August 25, 2006.
- Registration opens mid-June; Advanced registration fee is \$300USD
- Breakfasts and lunches are included
- Hosts to sponsor of a social event on Wednesday evening at the summit
- Travel and transportation issues: citizens from certain countries may require a Canadian visa. [www.vec.ca/english/9/exemptions.cfm](http://www.vec.ca/english/9/exemptions.cfm)



IEEE Session 45,  
September 25-28, 2006



# Welcome to one of the top resort in North America



Located 80 miles (130 km) north of Montreal, station Mont Tremblant is a leading four seasons mountain pedestrian village resort in North America attracting and retaining a broad array of guests from around the world for its “Joie de vivre” and world-class attractions such as skiing, conventions, golf, cultural, outdoor and leisure activities.

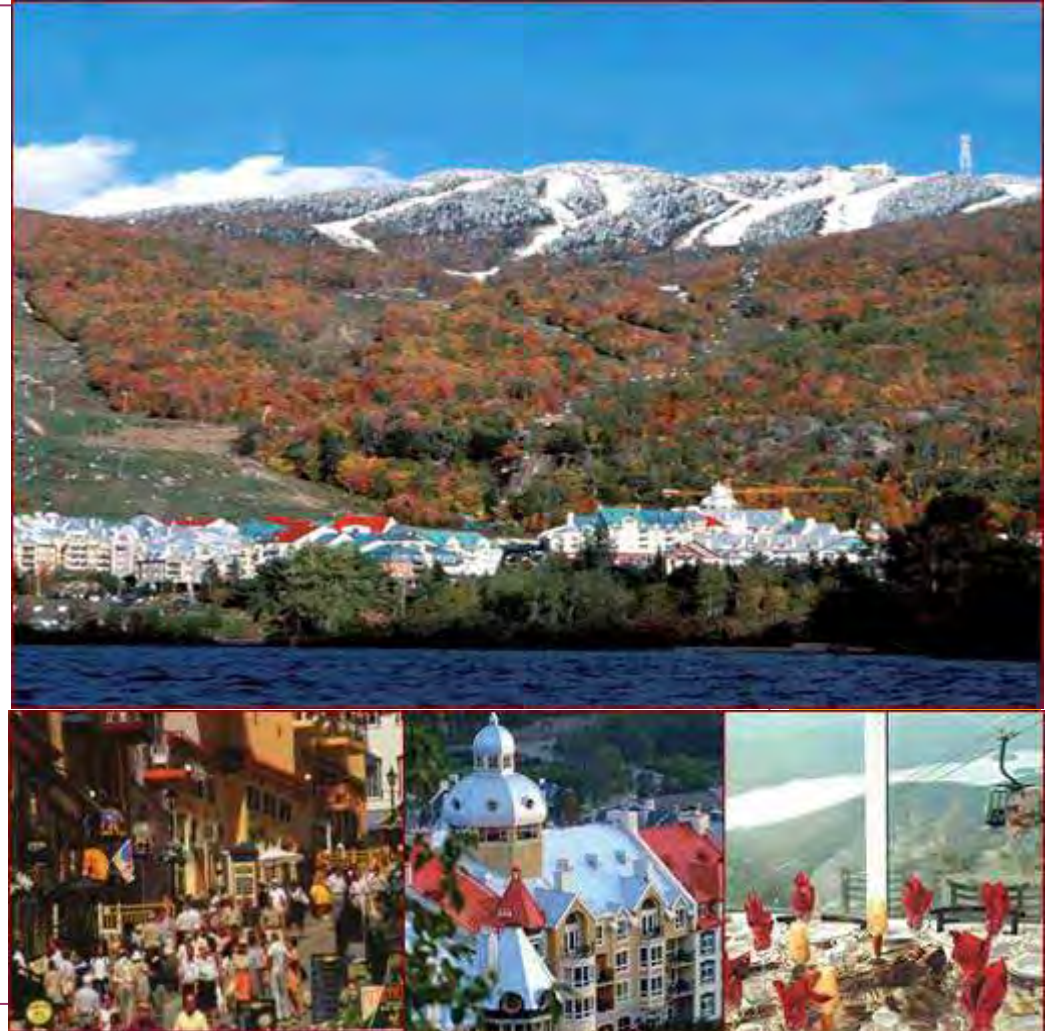

IEEE Session 45,  
September 25-28, 2006



# Statistics - Year 2005



- **Number of visitors -- 2,3 millions Annual**
- **Number of employees -- 2,800 +**
- **Annual Sales -- 100 millions \$**
- **Number of lodging units -- 2 225**
- **1 Convention Centre**
- **2 Championships Golf Courses**
- **1 Indoor and outdoor Aquaclub Center**
- **1 Beach & Tennis Club**
- **Ski Season: November 19, 2004 to April 17, 2005**



IEEE Session 45,  
September 25-28, 2006

# Pedestrian village





# Numerous activities!



- Shopping in our 42 boutiques
- Gastronomy and fine cuisine
- La Source Aquaclub or Amerispa
- Bicycling and In-line Skating
- Hiking on the mountain
- Beach & Tennis Club
- Cruises on lake Tremblant
- Airplane tours
- Visit or test drive - Le Circuit Mont Tremblant



Exchange Rate 1 CAD = 0.90 USD



IEEE Session 45,  
September 25-28, 2006

# Lodging in the Pedestrian Village

- La Tour des Voyageurs(4\*): rooms from \$105CAD \$155CAD. Next to convention Center.
- L'Ermitage (4\*): rooms from \$115CAD to \$135CAD. 2 minute walk to convention center
- Westin Resort & Spa (5\*): rooms \$175CAD. 5 minute walk to convention center





# The Convention Centre



- 23 000 sq. ft. of meeting space
- Meeting for more than 400 persons
- 12 meeting rooms
- Banquet facilities for all type of functions



IEEE Session 45,  
September 25-28, 2006



# Convention Centre Room Layout

Rez-de-chaussée / Ground Floor

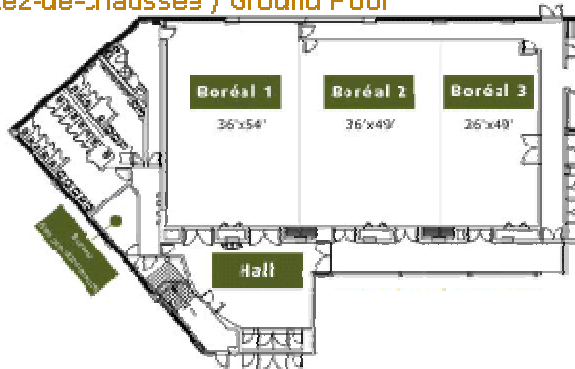

- 3 rooms on ground floor
- Capacity from 90 to 400 persons.

Étage / 1st Floor

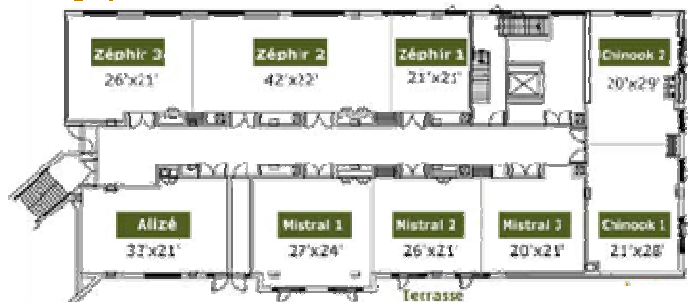

- 9 rooms on first floor
- Capacity from 30 to 150 persons.



# Banquet at the Summit



- LE GRAND MANITOU Restaurant is located at the top of Tremblant Mountain (2800 feet)
- Exclusive free gondola ride to get to the restaurant
- Fine cuisine and high end services
- Unique View



IEEE Session 45,  
September 25-28, 2006



# Weather Statistics for September



- Maximum: 20 °C / 68 °F
- Minimum: 1 °C / 34 °F
- Mean: 15 °C / 59 °F
- Monthly Precipitation: 100 mm of rain
- 0 cm of Snow
- Symphony of Colors





# Getting There



- Montréal-Trudeau International Airport (YUL)
- A shuttle schedule will be provide from Montreal Airport to Mont Tremblant and coming back; 80 miles (130 km).
- Mont Tremblant International Airport (CYFJ)  
Voyager Airlines flies non stop from Toronto and New York to Tremblant, [www.mtia.ca](http://www.mtia.ca), or from Montreal YUL.

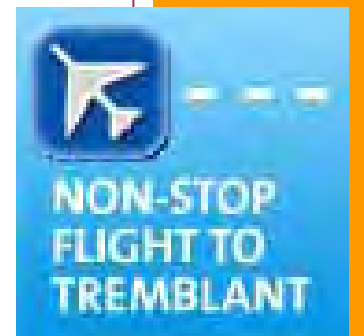



# See you there ...



IEEE Session 45,  
September 25-28, 2006