

# 802.16 Interim Session #49 Portland Site Proposal

Document Number: IEEE C802.16-07/002

Date Submitted: January 16, 2007

Source:

Jose Puthenkulam ([jose.p.puthenkulam@intel.com](mailto:jose.p.puthenkulam@intel.com)), Jennifer Reyes ([jennifer.r.reyes@intel.com](mailto:jennifer.r.reyes@intel.com))  
Intel Corporation  
2111 NE 25<sup>th</sup> Avenue, JF3-336  
Hillsboro, OR

Venue: IEEE 802.16 Session #47 London, UK

Base Document: None

Purpose: Overview of May 7-10, 802.16 Interim Session #49 Portland, Oregon Site Proposal

Notice:

This document has been prepared to assist IEEE 802.16. It is offered as a basis for discussion and is not binding on the contributing individual(s) or organization(s). The material in this document is subject to change in form and content after further study. The contributor(s) reserve(s) the right to add, amend or withdraw material contained herein.

Release:

The contributor grants a free, irrevocable license to the IEEE to incorporate material contained in this contribution, and any modifications thereof, in the creation of an IEEE Standards publication; to copyright in the IEEE's name any IEEE Standards publication even though it may include portions of this contribution; and at the IEEE's sole discretion to permit others to reproduce in whole or in part the resulting IEEE Standards publication. The contributor also acknowledges and accepts that this contribution may be made public by IEEE 802.16.

IEEE 802.16 Patent Policy:

The contributor is familiar with the IEEE 802.16 Patent Policy and Procedures <<http://ieee802.org/16/ipr/patents/policy.html>>, including the statement "IEEE standards may include the known use of patent(s), including patent applications, provided the IEEE receives assurance from the patent holder or applicant with respect to patents essential for compliance with both mandatory and optional portions of the standard." Early disclosure to the Working Group of patent information that might be relevant to the standard is essential to reduce the possibility for delays in the development process and increase the likelihood that the draft publication will be approved for publication. Please notify the Chair <<mailto:chair@wirelessman.org>> as early as possible, in written or electronic form, if patented technology (or technology under patent application) might be incorporated into a draft standard being developed within the IEEE 802.16 Working Group. The Chair will disclose this notification via the IEEE 802.16 web site <<http://ieee802.org/16/ipr/patents/notices>>.



**802.16 Interim Session #49**  
**Hosted by Intel Corporation**

**May 7-10, 2007**  
**(Please note Date change!)**

**Portland, Oregon**  
**USA**

# Registration

- Registration Fees
  - Early registration
    - US\$400 per attendee
    - cut-off April 15, 2007
    - includes daily breakfast, lunch, break services & Wednesday night reception
  - Late registration
    - US\$450 per attendee
    - after April 15, 2007
  - How to register
    - Online registration available February 5, 2007
    - May also register on-site

# Doubletree Hotel & Executive Meeting Center

- Hotel has 750 sleeping rooms
- Features on property
  - Business Center
  - High Speed Internet Access
  - Restaurant & Room Service
  - Fitness Center
  - Concierge
  - Pool
- Perks
  - Only 10.5 miles from PDX
  - Located near Lloyd Center, Portland's Largest Shopping Center
  - Walking distance to Rose Garden Arena & Memorial Coliseum
  - Part of the light rail's "Fareless Square"



# Meeting Rooms

- All Meeting Rooms
  - All meeting rooms capable splitting into smaller meeting spaces
  - Set Classroom-style with power supplies for each seat
  - WiFi Connectivity provided by Verilan throughout meeting spaces
- Meeting Facilities
  - 38,000 sq ft. total
  - We will be the only conference at hotel



**DOUBLETREE HOTEL & EXECUTIVE MEETING CENTER  
PORTLAND-LLOYD CENTER - FIRST LEVEL**

- 1 LLOYD CENTER BALLROOM
- 1a MULTNOMAH
- 1b HOLLADAY
- 1c BROADWAY
- 1d WEIDLER
- 1e HALSEY

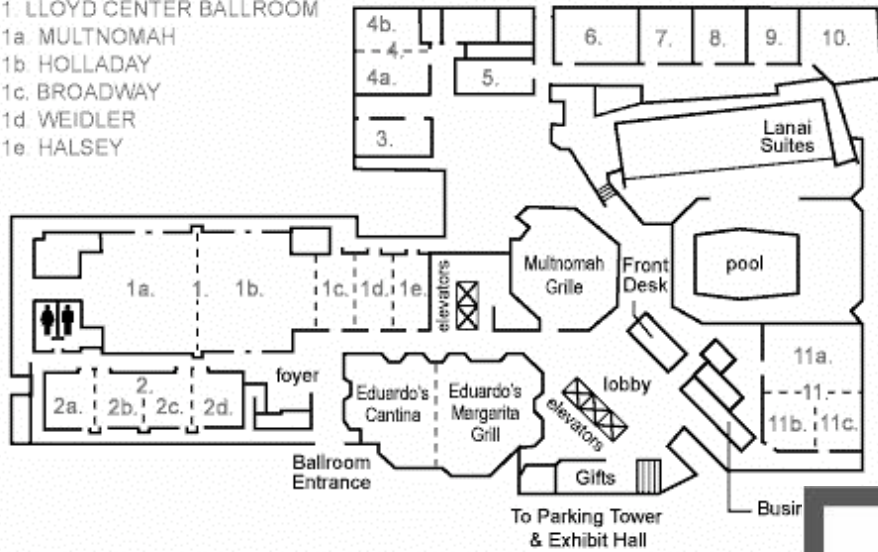

- 2 WILLAMETTE BALLROOM
- 2a HAWTHORNE
- 2b SELLWOOD
- 2c ROSS ISLAND
- 2d MORRISON
- 3 WASHINGTON
- 4 ADAMS/JEFFERSON
- 4a. ADAMS
- 4b. JEFFERSON
- 5. HAMILTON
- 6. ROOSEVELT
- 7. MADISON
- 8. LINCOLN
- 9. GRANT
- 10. JACKSON
- 11. PACIFIC NORTHWEST
- 11a. OREGON
- 11b. ALASKA
- 11c. IDAHO

# Doubletree's meeting room layouts

**All Classroom-style set-up:**

- Lloyd Center Ballroom: 600pp
- Willamette Ballroom: 125pp
- Pacific Northwest Ballroom: 175pp

These rooms can be split as required

**DOUBLETREE HOTEL & EXECUTIVE MEETING CENTER  
PORTLAND-LLOYD CENTER - SECOND LEVEL**

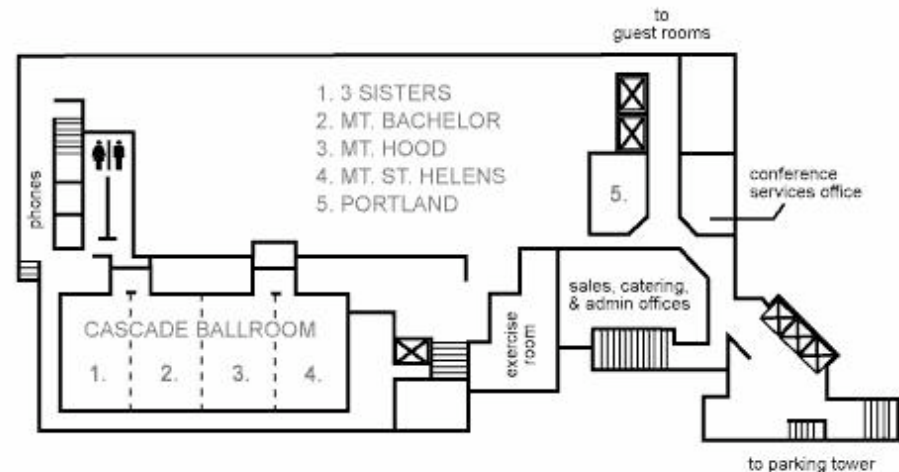

**Cascade Ballroom:**

- Meal service for 360
- Banquet rounds

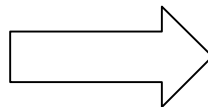

# Sleeping Rooms

- Lodging Information (nights of May 7-10, 2007)
  - \$134 per night
    - Includes in-room connected high-speed internet access & complimentary parking
    - Hilton Honors points & airline miles will be earned for room reservations
  - Room block held until April 15, 2007
    - Reservations received after the cutoff date will be honored at the IEEE rate *based on hotel availability*.
    - The IEEE rate will apply three (3) days before and three (3) days following the official dates of the meeting, based on space availability.
  - Check-in time is 3:00 PM, check-out time is 12:00 Noon
    - Early baggage check-in available
- Lodging reservations are available on the hotel's website

# Air Transportation:

## *Getting to Portland*

- Portland International Airport (PDX)
  - Direct connections from:
    - U.S.
      - San Francisco (SFO) & San Jose (SJC)
      - Seattle (SEA)
      - Los Angeles (LAX)
      - Chicago (OHR)
      - Dallas (DFW)
      - Washington D.C. (Dulles)
    - International
      - Frankfurt (FRA)
      - Tokyo/Narita



# Ground Transportation

- From Portland Int'l Airport (PDX)
  - Rental Cars
    - Note: Hotel parking is complimentary
  - Taxi cabs
  - Personal shuttles available
    - Cascade Coach Towncar Service
  - Public transportation light rail system "The MAX"
    - Pick-up outside of PDX baggage claim and travels straight to hotel with minimal stops (approximately 20 minute ride).
- Around Portland
  - Great public transportation
  - [www.trimet.org](http://www.trimet.org), includes:
    - 44-mile light rail system
      - Called "The MAX"
    - Bus system
    - Portland Streetcar



# US Visa Information

- Visa invitation letters will be provided by Intel via the registration
- Invitation letters will be available through the registration website after you receive your confirmation code.

# Resources & Assistance

- VTM

- Portland area event management company
- Will manage all registration & on-site events

- Intel

- Jose Puthenkulam, Official Host
- Jennifer Reyes

**Thank you & we'll see you May!**

