

Proposal to host the 22-26 January 2001 IEEE 802.16 meeting in Ottawa, Canada

Document Number:

IEEE 802.16c-00/01

Date Submitted:

2000-11-06

Source:

Jose M. Costa

Nortel Networks

P.O. Box C-3511

Ottawa, Ontario

CANADA K1Y 4H7

Voice: +1 613 763-7574

Fax: +1 613 765-1225

E-mail: costa@nortelnetworks.com

Venue:

6-9 November 2000, Tampa, Florida

Base Document:

N/A

Purpose:

Nortel Networks offers to host the 22-26 January 2001 meeting of IEEE 802.16 in Ottawa, Ontario, Canada.

Notice:

This document has been prepared to assist IEEE 802.16. It is offered as a basis for discussion and is not binding on the contributing individual(s) or organization(s). The material in this document is subject to change in form and content after further study. The contributor(s) reserve(s) the right to add, amend or withdraw material contained herein.

Release:

The contributor grants a free, irrevocable license to the IEEE to incorporate text contained in this contribution, and any modifications thereof, in the creation of an IEEE Standards publication; to copyright in the IEEE's name any IEEE Standards publication even though it may include portions of this contribution; and at the IEEE's sole discretion to permit others to reproduce in whole or in part the resulting IEEE Standards publication. The contributor also acknowledges and accepts that this contribution may be made public by IEEE 802.16.

IEEE 802.16 Patent Policy:

The contributor is familiar with the IEEE 802.16 Patent Policy and Procedures (Version 1.0) <http://ieee802.org/16/ipr/patents/policy.html>, including the statement "IEEE standards may include the known use of patent(s), including patent applications, if there is technical justification in the opinion of the standards-developing committee and provided the IEEE receives assurance from the patent holder that it will license applicants under reasonable terms and conditions for the purpose of implementing the standard."

Early disclosure to the Working Group of patent information that might be relevant to the standard is essential to reduce the possibility for delays in the development process and increase the likelihood that the draft publication will be approved for publication. Please notify the Chair <mailto:r.b.marks@ieee.org> as early as possible, in written or electronic form, of any patents (granted or under application) that may cover technology that is under consideration by or has been approved by IEEE 802.16. The Chair will disclose this notification via the IEEE 802.16 web site

<http://ieee802.org/16/ipr/patents/letters>.



Nortel Networks offers to host the 22-26 January 2001 meeting of IEEE 802.16 in Ottawa, Canada, at the following hotel:

**Crowne Plaza Ottawa
101 Lyon Street
Ottawa, ON
K1R 5T9**

Tel.: +1 613 237-3600

Fax: +1 613 237-2351

E-mail: crowneplazaottawa@chipreit.com

<http://www.crowneplazaottawa.com>



CANADA

MONTREAL

OTTAWA

BOSTON

TORONTO

DETROIT

NEW YORK

CHICAGO

PITTSBURGH

WASHINGTON
DC

UNITED STATES

RALEIGH

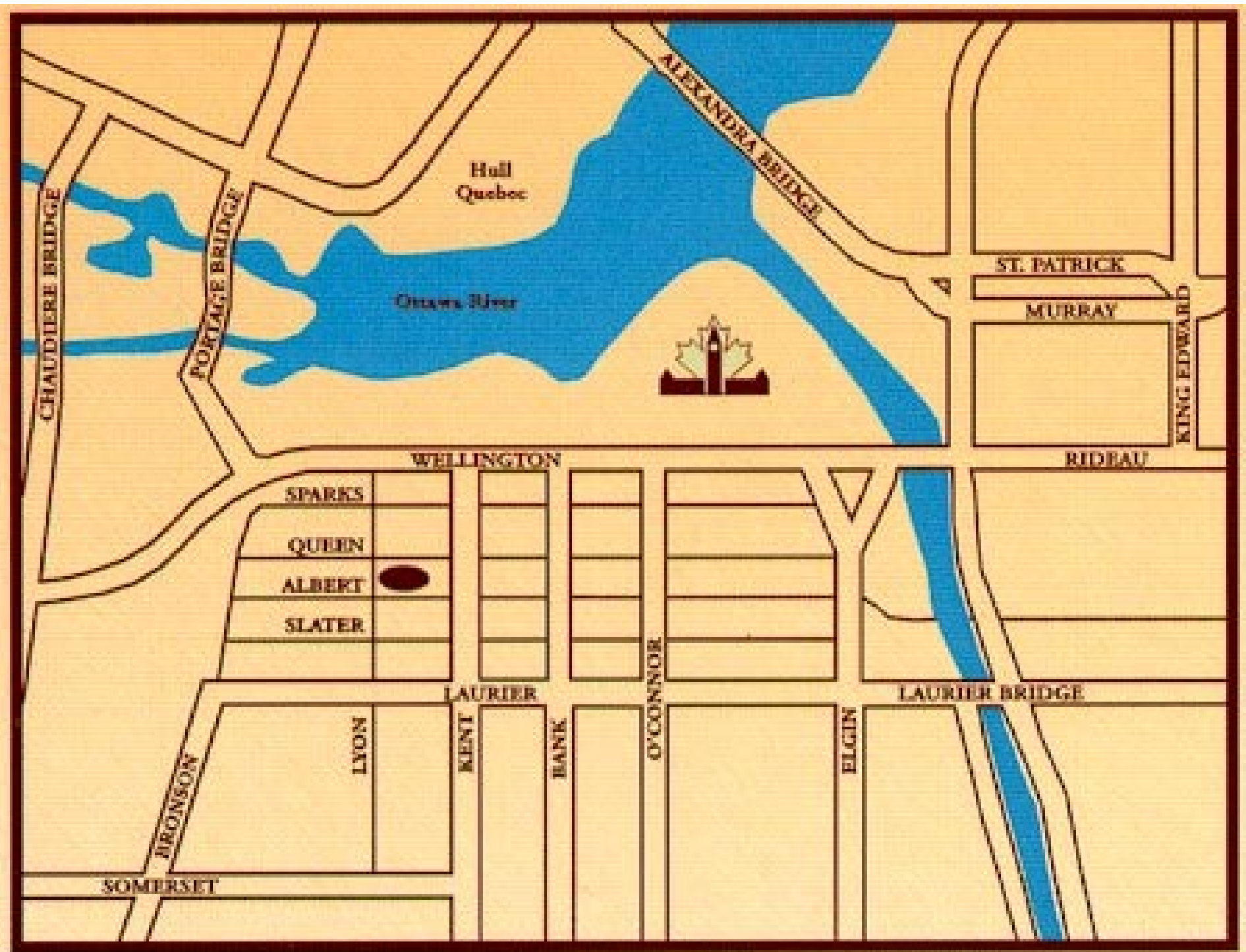

Crowne Plaza Ottawa

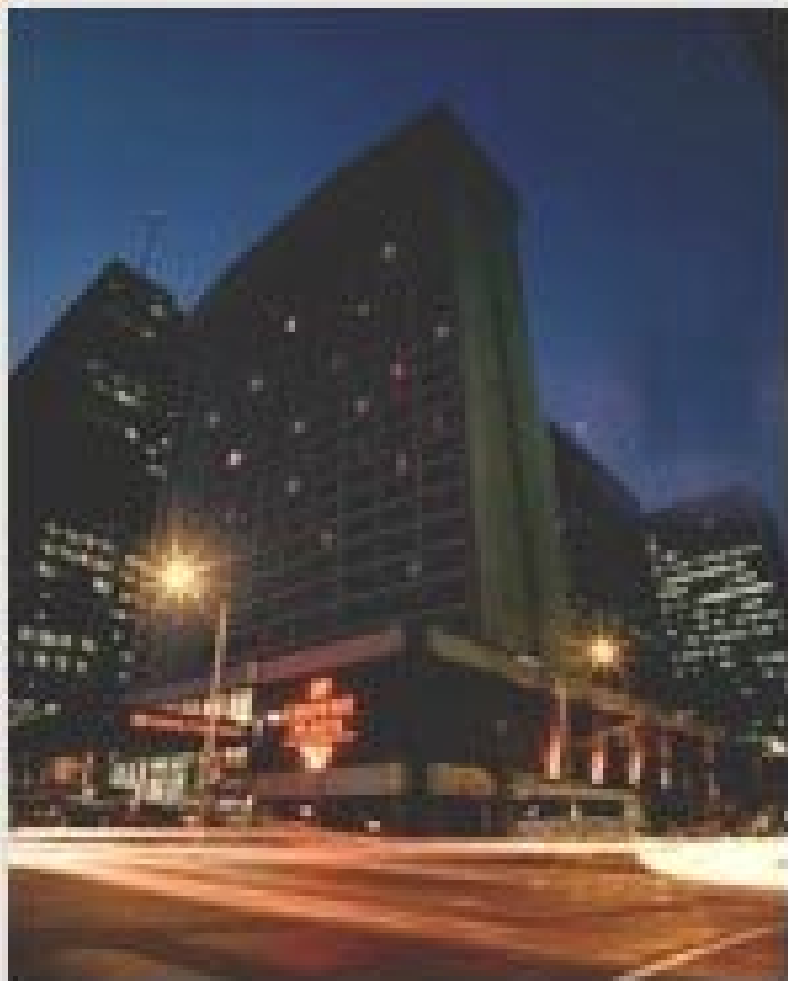

Crowne Plaza Ottawa

- **The Crowne Plaza Ottawa is ideally located downtown overlooking the beautiful city of Ottawa, in the heart of the business district and just blocks to the Parliament Buildings, museums, shopping and attractions.**
- **Ottawa's most extensive hotel health club with indoor pool.**
- **411 guestrooms including 19 suites.**
- **After an \$11 million renovation to all 411 guest rooms and public areas including the Crowne Club floors & lounge – the Crowne Plaza Ottawa offers business and leisure travelers a chic and cosmopolitan décor.**
- **Two Executive Crowne Club floors that include bathrobe, mineral water, complimentary continental breakfast and evening hors'doeuvres.**

Crowne Plaza Ottawa: Services

- **Car rental desk**
- **Attached via underground walkway to shops & services of Place de Ville Towers**
- **Same day laundry/dry cleaning**
- **On site taxi stand**
- **News stand/gift shop**
- **Audio/Visual company on site**
- **Airport shuttle at a cost**
- **Hull Casino pick-up and drop-off available**
- **Concierge**
- **Ice machine on every third floor**
- **Safety deposit boxes**
- **Indoor parking**
- **Valet parking**
- **Business centre in main lobby**
- **Room service**



Crowne Plaza Ottawa

Meeting Rooms



Lower Level / Niveau inférieur

rue Queen Street

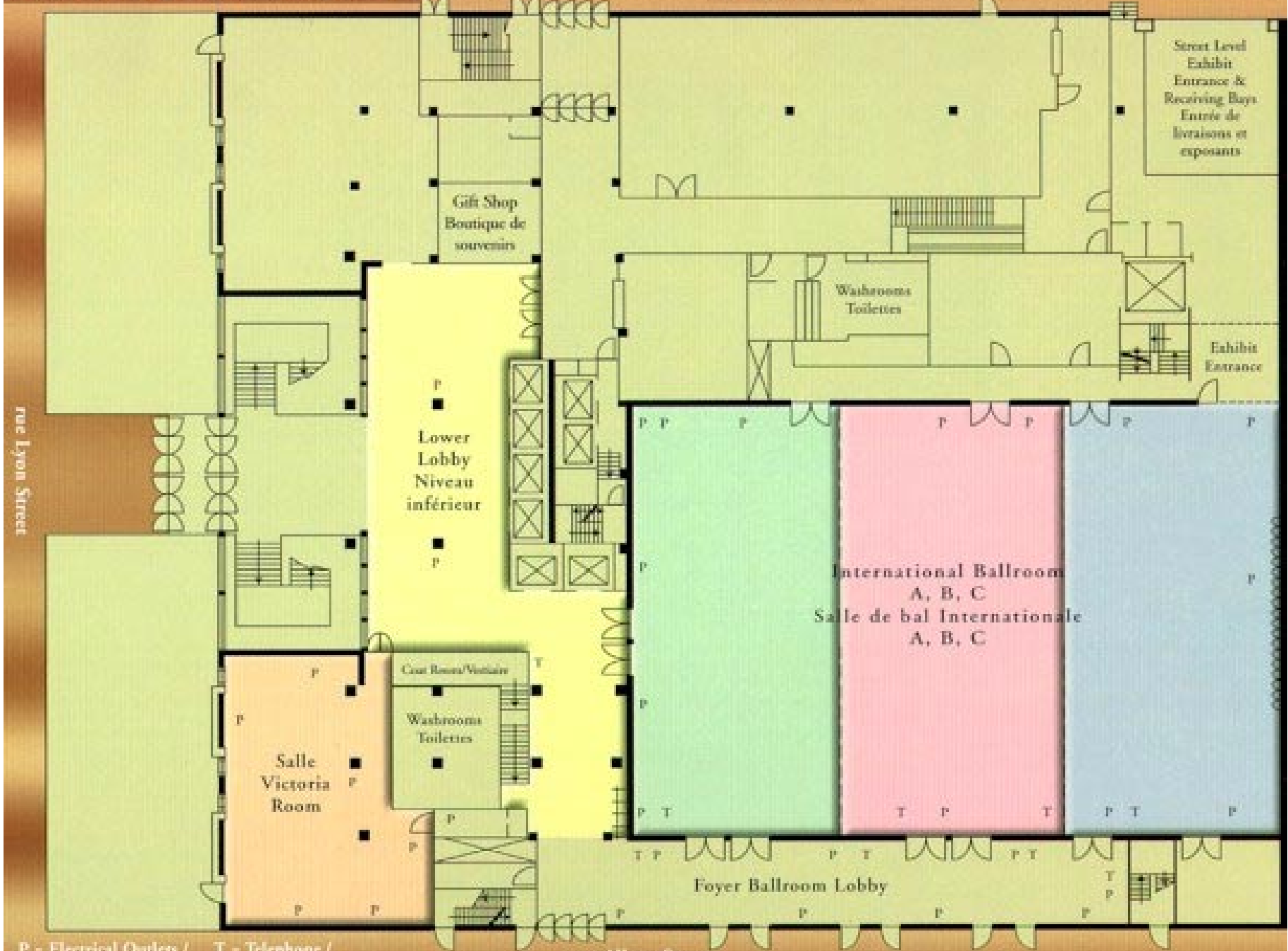

rue Lyon Street

rue Albert Street

P - Electrical Outlets / Courant électrique
T - Telephone / Téléphone

Convention Level / Niveau des congrès

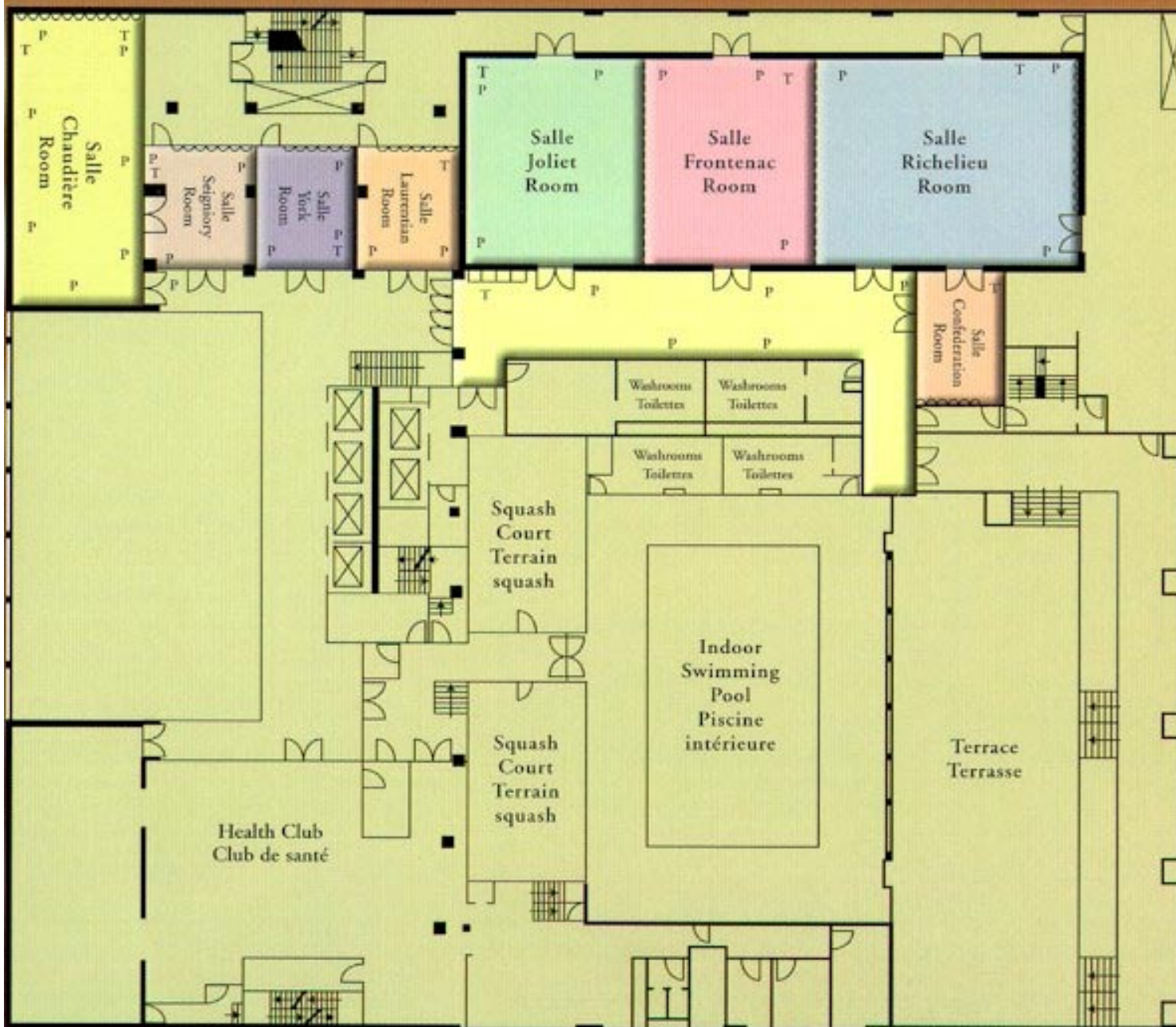

P = Electrical Outlets / Courant électrique / T = Telephone / Téléphone

Penthouse Level
Niveau penthouse

rue Lyon Street

rue Albert Street

rue Queen Street

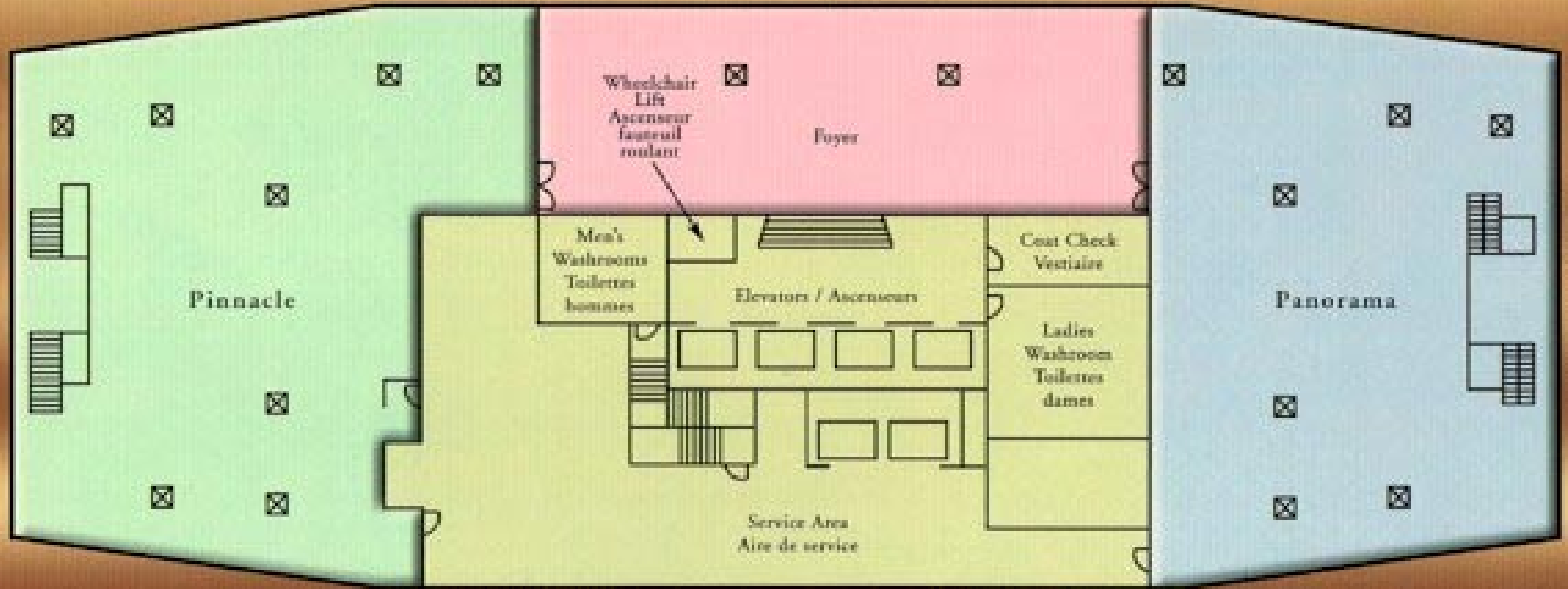

Crowne Plaza Ottawa

MEETING AND BANQUET ROOM CAPACITIES														
CARACTÉRISTIQUES DES SALLES DE RÉUNIONS ET BANQUETS														
Name of Room	Theatre	Classroom	U-shape	Hollow Square	Boardroom	Banquet Rounds 10	Dinner & Dance	Reception	Exhibits 10'x10'	Exhibits 8'x8'	Dimensions in feet	Square Feet	Meters	Ceilings Heights
Nom de la salle	Théâtre	École	Style U	Carré ouvert	Conférence	Tables Rondes	Diner danse	Réception	Kiosques 10'x10'	Kiosques 8'x8'	Dimensions Pied carré	Pied Carré	Mètres	Hauteur Plafond
LOWER LEVEL - NIVEAU INFÉRIEUR														
<i>International Ballroom</i>	1200	600	n/a	n/a	n/a	900	750	1500	60	90	120x82	9840	915	14.8/4.5
<i>Section A</i>	350	175	60	72	50	300	250	500	20	30	40x82	3280	305	14.8/4.5
<i>Section B</i>	350	175	60	72	50	300	250	500	20	30	40x82	3280	305	14.8/4.5
<i>Section C</i>	350	175	60	72	50	300	250	500	20	30	40x82	3280	305	14.8/4.5
<i>Ballroom Foyer</i>											15x95	1425		14.8/4.5
<i>Victoria</i>	120	60	40	40	35	120	n/a		10	10	23x50	1166	108	14.8/4.5
CONVENTION LEVEL - NIVEAU DES CONGRES														
<i>Grand Salon</i>	400	200	80	90	n/a	300	220	400	14	25	103x36	3708	341	10.6/3.2
<i>Richelleu</i>	180	80	45	50	35	120	90	110	7	8	43x36	1548	143	10.6/3.2
<i>Frontenac</i>	110	60	40	40	35	90	50	110	6	7	30x36	1080	99	10.6/3.2
<i>Joliet</i>	110	60	40	40	35	90	50	110	6	7	30x36	1080	99	10.6/3.2
<i>Chaudière</i>	120	60	36	40	35	80	n/a	110	5	7	22x50	1100	102	10.9/3.3
<i>Seignory</i>	20	12	n/a	12	10	20	n/a	20	1	2	21x18	378	35.2	9.1/3.05
<i>Laurentian</i>	20	12	n/a	12	10	20	n/a	20	1	2	21x16	336	31.4	10.0/3.05
<i>York</i>	20	12	n/a	12	10	20	n/a	20	1	2	21x16	336	31.4	9.0/2.7
<i>Confederation</i>	20	12	n/a	12	10	20	n/a	20	1	1	20x14	280	26.2	10.2/3.05
PENTHOUSE LEVEL (PH) - NIVEAU PENTHOUSE														
<i>PH Foyer</i>												1600		
<i>Panorama</i>	150	60	40	45	25	150	120	150	n/a	n/a		2230		10.6/3.2
<i>Pinnacle</i>	150	60	40	45	25	200	140	230	n/a	n/a		2580		10.6/3.2



**Asian and North American
Cuisine...**

Chic and contemporary



Guestrooms

**Working Desk with
Ergonomic Chair...**



**...2 phone lines
with data ports**

Crowne Plaza Ottawa: Guest Rooms

- **Two phone lines with data port**
- **Guest voice mail**
- **Non smoking floors available**
- **Iron and board**
- **Hairdryer and coffee maker**
- **25" color television with remote control**
- **Electronic card lock system**
- **Individual climate control**
- **On command movies/video games with express check-out**
- **Opening fresh air vents in all rooms**
- **Working desk with ergonomic chair**
- **Long length mirror**
- **Am/Fm clock radio**

How much will it cost?

- **Note the exchange rate (5 November 2000):**

One U.S. dollar (USD 1)

buys

1.51 Canadian dollars (CAD 1.51)

- **Or USD 0.66 per Canadian dollar.**

Arrangement Details

- **Estimated registration fee (to cover meeting rooms, continental breakfast, morning coffee break, afternoon coffee break including cookies/snack, and audiovisual equipment): about USD 140-150.**
- **Nortel Networks would pay for any deficit and any excess would be given to IEEE 802.16.**
- **Guestrooms: CAD 119 (approximately USD 79).**
- **Nortel Networks would host a dinner on Wednesday night.**

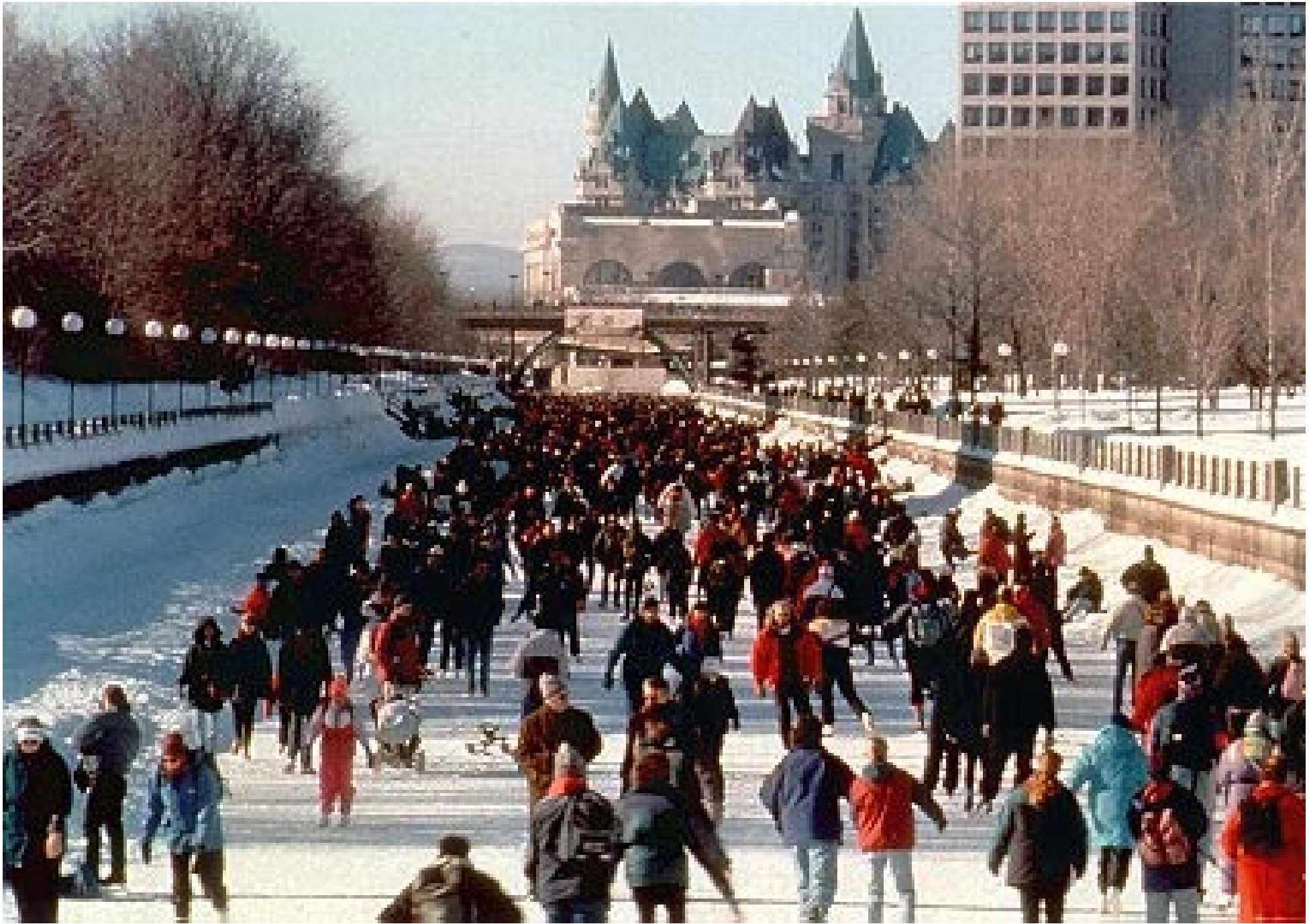

Ski



**Night Skiing
(1/2 hour away)**



Winterlude















The Byward Market







The Museum of Civilization





Gatineau Park

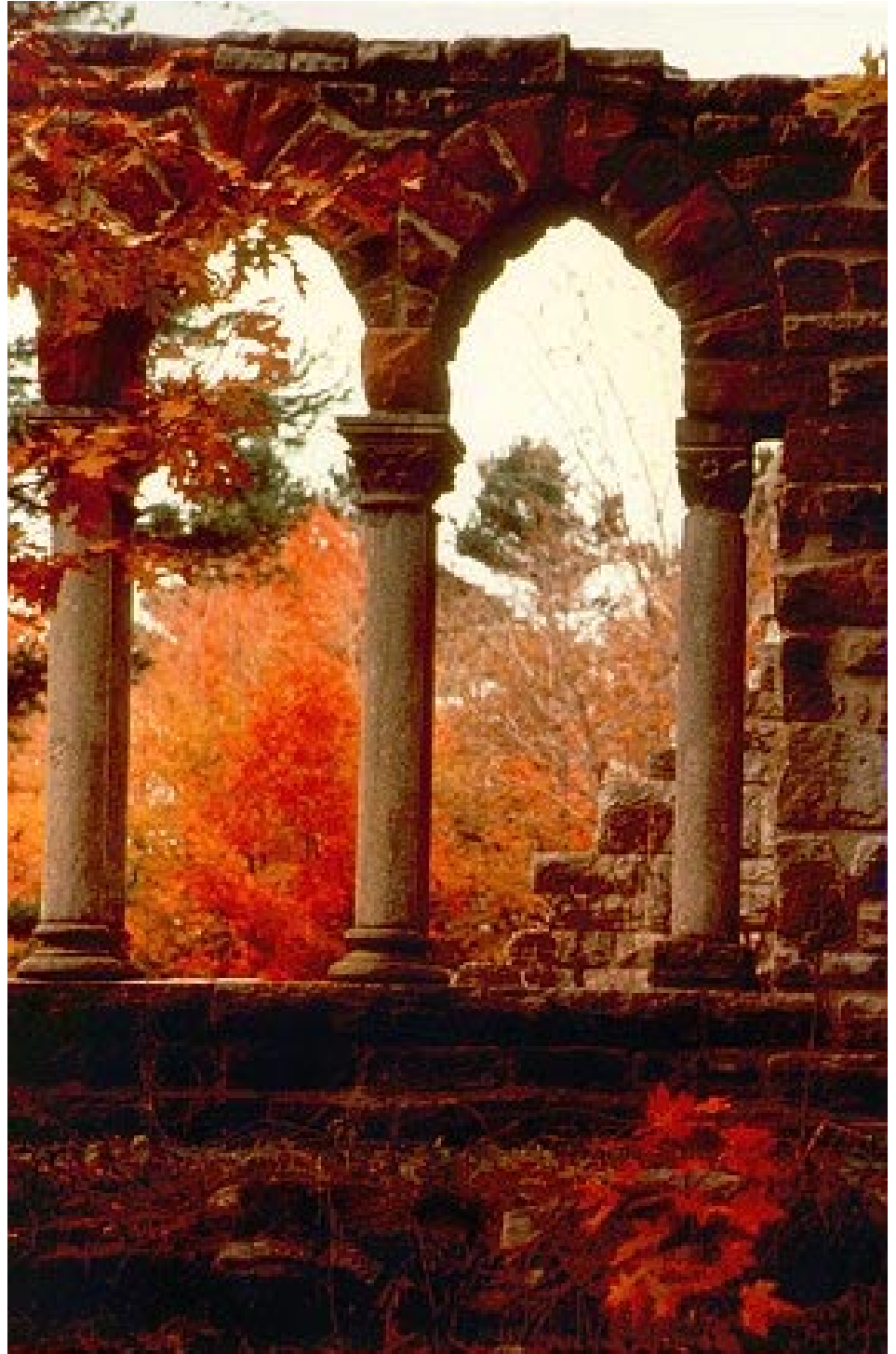

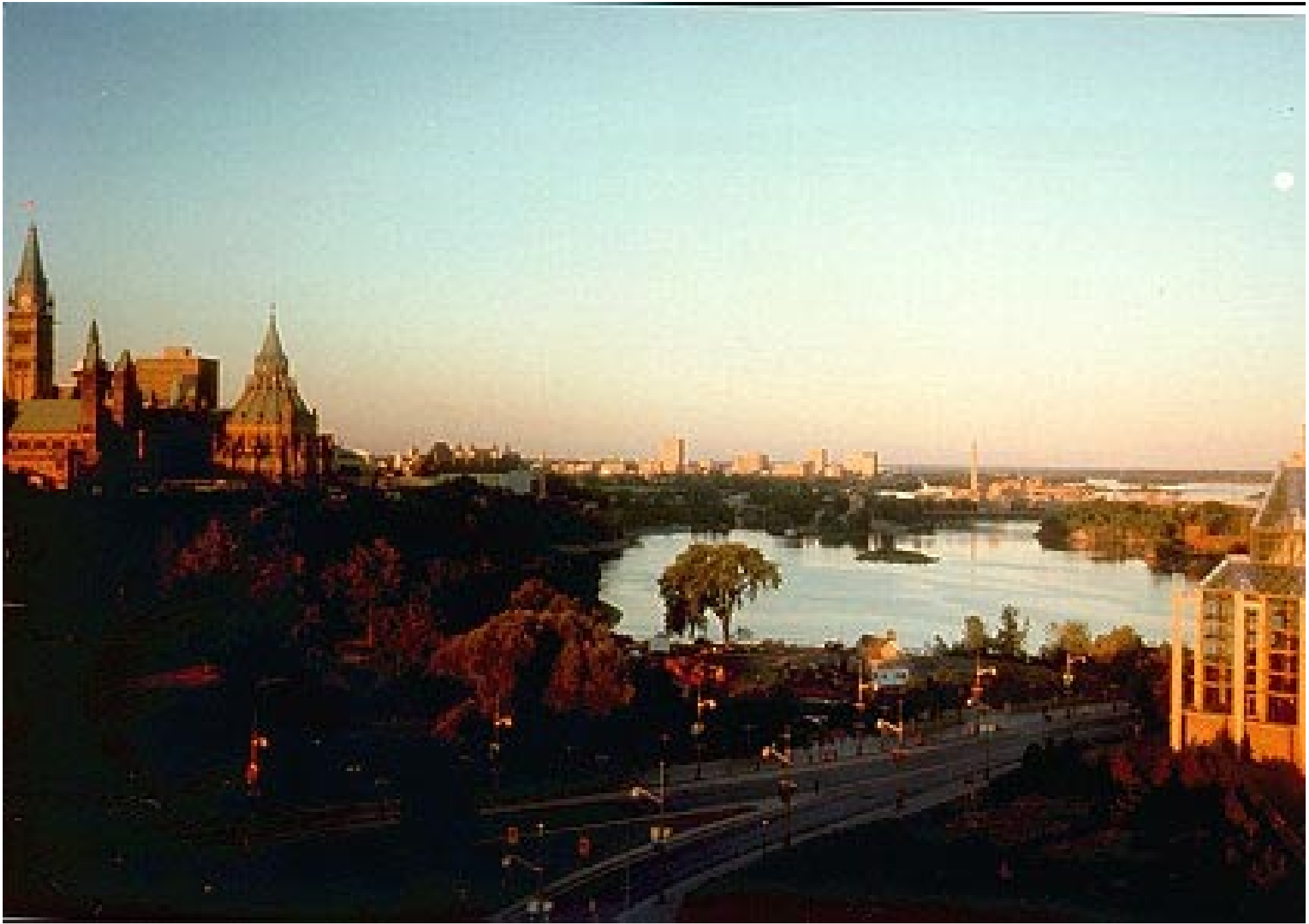



The Museum of Aviation



Royal Mint and War Museum



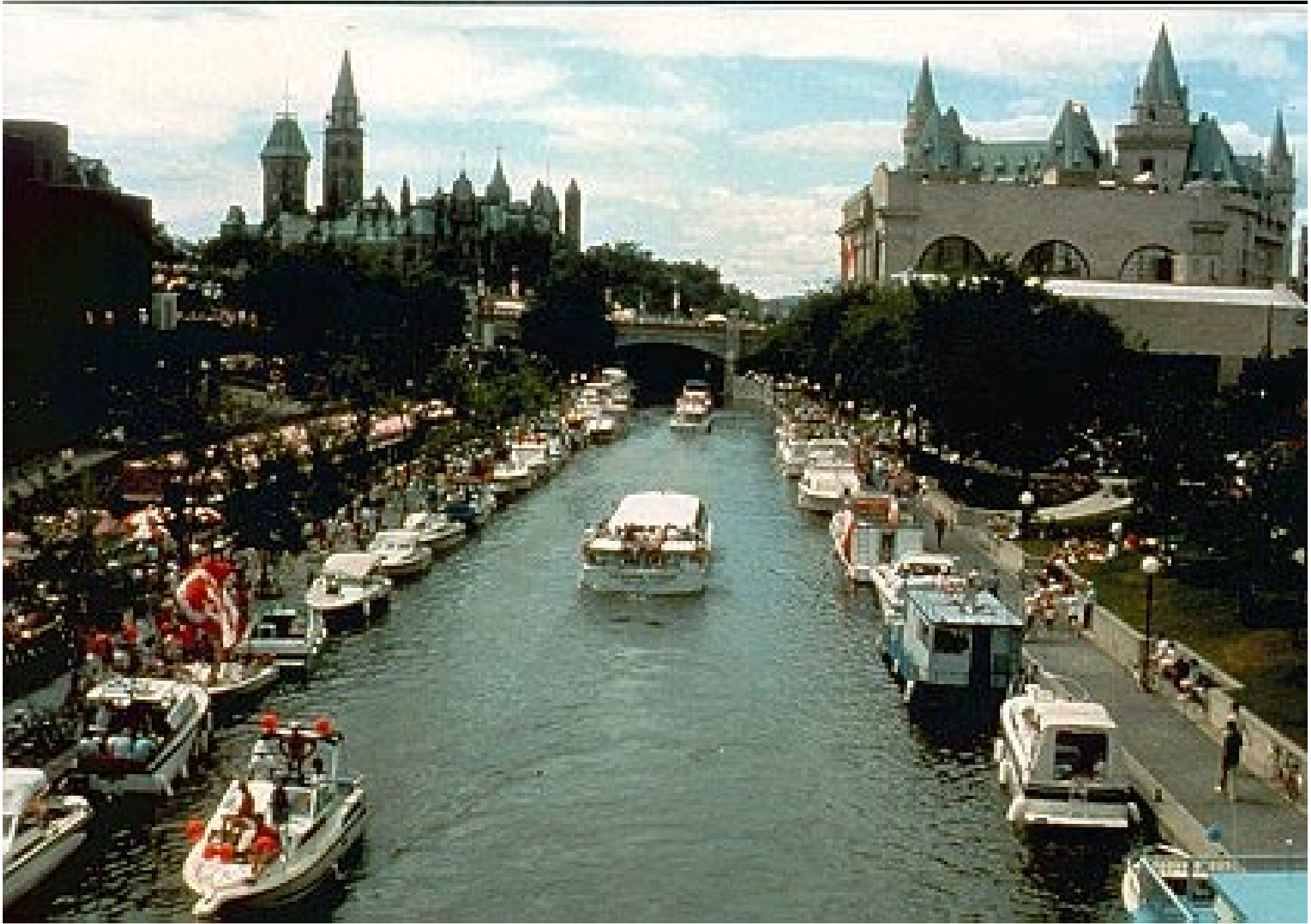



IEEE 802.16

Let's go!

**See you in
Ottawa!!!**