



## **IEEE 802 Plenary Session**

Hyatt Regency Embarcadero, San Francisco, CA

## **Mid-Session Network Services Report**

July 15<sup>th</sup>, 2009

### **Summary**

VeriLAN Event Services, Inc. (VeriLAN) is providing comprehensive network services for the IEEE 802 July 2009 Plenary meeting at the Hyatt Regency San Francisco at Embarcadero in San Francisco, CA. We are pleased to report after a full infrastructure deployment, only one minor issue on Monday afternoon during PM1. The network is stable and supporting in excess of 1200 wireless clients.

**Issue:** Network loading on the DHCP server (Griffin) led to a brief degradation of service during PM1 on Monday afternoon.

**Resolution:** The service degradation, identified by VeriLAN network monitoring tools, indicated that the high load was the result of a large number of attendees performing remote global document synchronization with Mentor. DHCP services were migrated to Newton and all systems are now functioning normally.

The VeriLAN Network Help Desk is providing support for all attendees during scheduled meeting hours. All Help Desk support requests were addressed and fully resolved by VeriLAN staff.

The property is fed by a 45Mbps symmetrical DS3 connection to the Internet. We were given unrestricted access to the bandwidth, which is shared with the guest rooms and administrative offices. Comprehensive LAN and WLAN infrastructure including managed level-3 switches were configured and deployed in the MDF, IDFs and meeting rooms located on 4 convention floors and 3 guest-room floors. A total of 4 IDF's were interconnected to the MDF via fiber links, with one IDF using a copper line. Network traffic statistics are shown in Figure 1. Internet usage for the last 24 hour period is shown in Figure 2. Internet usage for the last seven days is shown in Figure 3. Internet usage for the last twelve months is shown in Figure 4.



Traffic statistics - Wed Jul 15 09:48:00 2009

Interface	Period	Direction	Current rate	Hour	Day	Week	Month
EXTERNAL	Current	In	22.1 Mbits/s	9.2 GB	22.5 GB	282.8 GB	329.3 GB
		Out	4.1 Mbits/s	3.7 GB	6.8 GB	106.4 GB	110.5 GB
	Previous	In		9.5 GB	131.1 GB	25.2 GB	0.0 KB
		Out		2.1 GB	51.9 GB	3.6 GB	0.0 KB
MANAGEMENT	Current	In	150.6 Kbits/s	68.1 MB	226.5 MB	21.9 GB	25.8 GB
		Out	281.1 Kbits/s	125.8 MB	911.3 MB	24.5 GB	68.5 GB
	Previous	In		65.2 MB	7.6 GB	3.5 GB	0.0 KB
		Out		208.3 MB	6.6 GB	23.8 GB	0.0 KB
open	Current	In	3.8 Mbits/s	3.4 GB	6.3 GB	83.8 GB	84.0 GB
		Out	19.6 Mbits/s	8.7 GB	19.6 GB	243.7 GB	246.2 GB
	Previous	In		2.1 GB	44.0 GB	109.5 MB	0.0 KB
		Out		8.9 GB	116.4 GB	1.4 GB	0.0 KB
secure	Current	In	134.6 Kbits/s	207.4 MB	293.8 MB	1.1 GB	1.1 GB
		Out	2.2 Mbits/s	364.8 MB	2.0 GB	14.6 GB	14.7 GB
	Previous	In		39.3 MB	452.4 MB	4.1 MB	0.0 KB
		Out		453.9 MB	8.1 GB	62.3 MB	0.0 KB

Figure 1. Internet Traffic Statistics

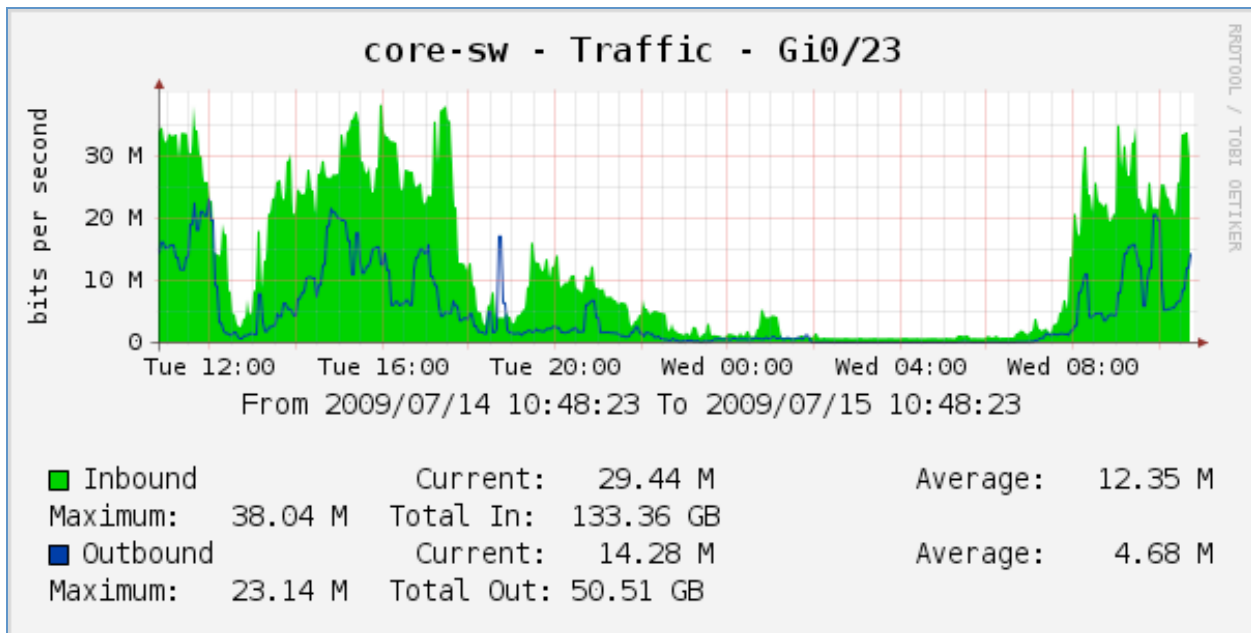

Figure 2. Internet Usage: past 24 hours (EST)

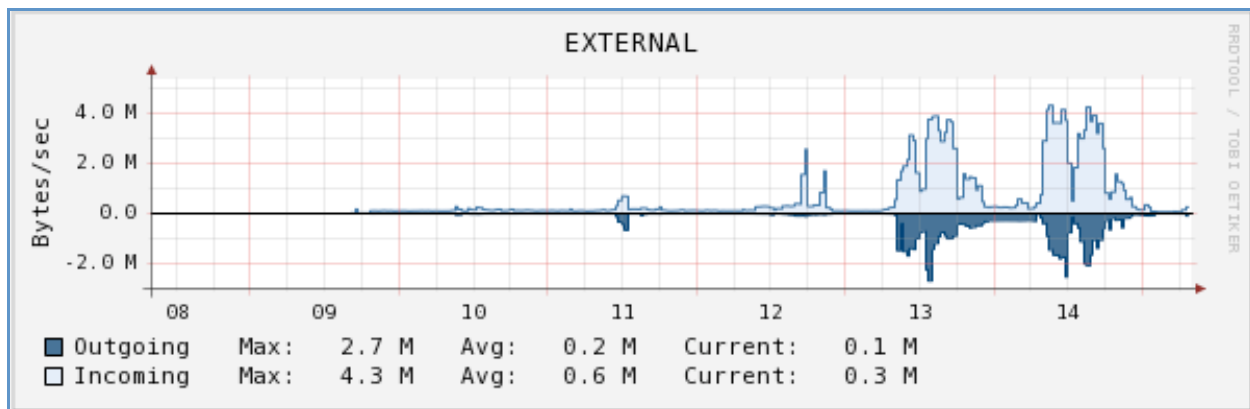

Figure 3. Internet Usage: past 7 days

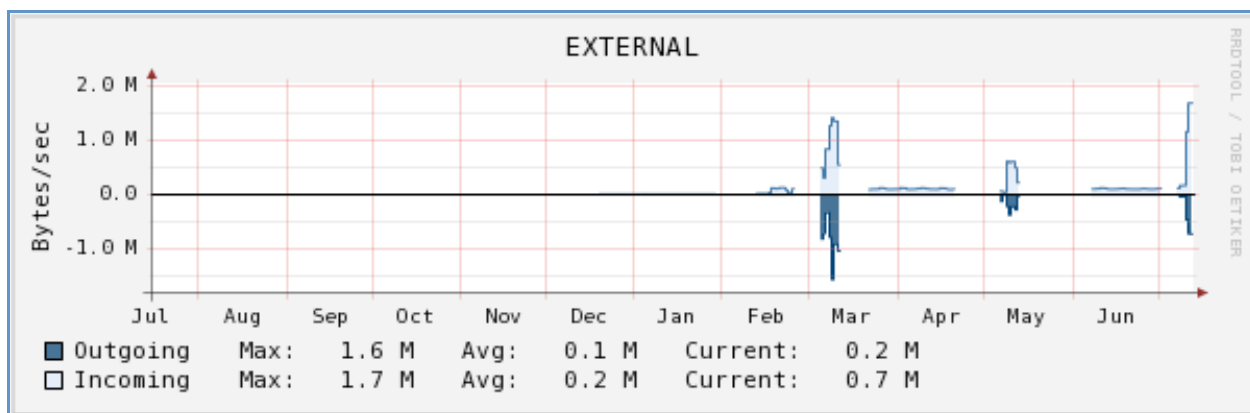

Figure 4. Internet Usage: past 12 months

### Network Deployment & Coverage

VeriLAN deployed 54 enterprise grade tri-modal IEEE 802.11a/b/g wireless access points throughout the Hyatt Regency Embarcadero to provide coverage for all meeting spaces. Target association density was 40 clients per WAP. VeriLAN is providing both Open and Secure (802.1x) networks to registered attendees. Figure 5 illustrates the location of the WAP deployments.

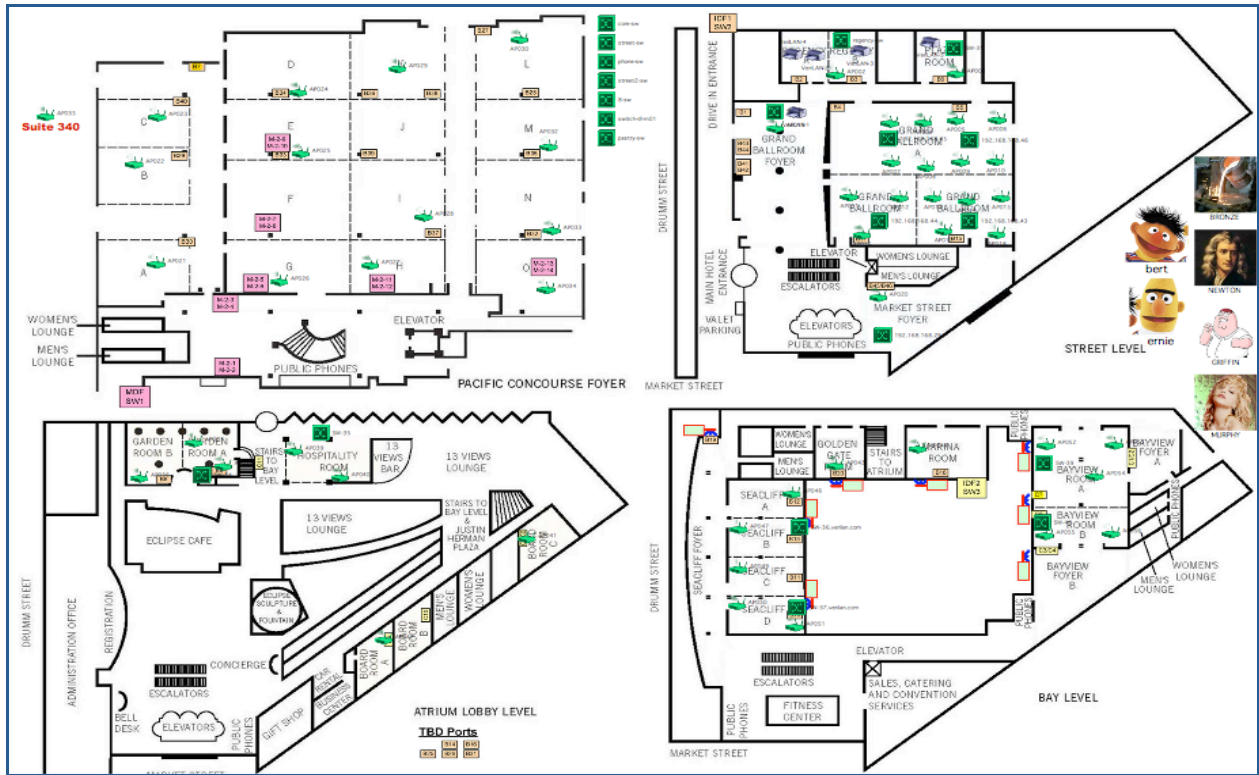

Figure 5. Wireless Access Point Deployment Plan